

Verbindungen mit **System**
The **POWER** of Partnership



3.01

► Skupina 3**strana**

| | |
|--|-------------|
| Lisovací kabelová oka Al | 3.03 – 3.05 |
| CUPAL podložky | 3.05 |
| Přechodová kabelová oka Al-Cu | 3.06 – 3.07 |
| Lisovací spojky Al a redukované lisovací spojky Al | 3.08 – 3.11 |
| Lisovací spojky Al DIN 48085, část 2, pevné v tahu | 3.12 |
| Lisovací spojky Aldrey, namáhané v tahu | 3.12 |
| Lisovací spojky DIN 48085, část 3, pro Al / Fe lana DIN 48204, namáhané v tahu | 3.13 |
| Lisovací spojky DIN 48085, část 3, pro Al / Fe lana DIN 48204, namáhané v tahu | 3.13 |
| Lisovací spojky Al s Cu-čepem | 3.14 |
| Přechodové spojky Al-Cu | 3.15 – 3.16 |
| Tabulka doporučeného nářadí | 3.17 – 3.18 |

AL - LISOVACÍ KABELOVÁ OKA PLNÁ

DIN 46329 ; plná, uzavřená

materiál: AL 99,5

povrch: mechanicky leštěno,

na přání pocínovaný (20 μm)

k připojení na Cu-sběrnice (vnitřní prostor)

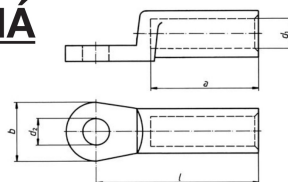

| jmenovitý průřez mm ² rm/sm | svorník se Ø | obj. číslo * | iden. číslo | rozměr mm | | | | | | počet slisování mech. hydr. | | nářadí | 100 ks ~ kg | balení ks |
|--|--------------------|--------------|-------------|----------------|----------------|------|----|-----|----|-----------------------------------|---|-------------------------------------|----------------|--------------|
| | | | | d ₁ | d ₂ | b | l | a | | | | | | |
| 16 | 25 | M 8 | 263 R/8** | 12 | 5,8 | 8,4 | 20 | 50 | 30 | 4 | 2 | tabulka strana 3.17 - 3.18 | 1,200 | 10 |
| | | M 10 | 263 R/10** | | | 10,5 | | | | | | | 1,200 | |
| 25 | 35 | M 8 | 264 R/ 8 | 12 | 6,8 | 8,4 | 25 | 50 | 25 | 4 | 2 | | 1,300 | 10 |
| | | M 10 | 264 R/10 | | | 10,5 | | | | | | | 1,240 | |
| | | M 12 | 264 R/12 | | | 13 | | | | | | | 1,220 | |
| 35 | 50 | M 8 | 265 R/8 | 14 | 8 | 8,4 | 25 | 62 | 42 | 5 | 2 | | 2,500 | 10 |
| | | M 10 | 265 R/10 | | | 10,5 | | | | | | | 1,980 | |
| | | M 12 | 265 R/12 | | | 13 | | | | | | | 2,500 | |
| 50 | 70 | M 8 | 266 R/8 | 16 | 9,8 | 8,4 | 25 | 62 | 42 | 5 | 2 | | 2,750 | 10 |
| | | M 10 | 266 R/10 | | | 10,5 | | | | | | | 2,700 | |
| | | M 12 | 266 R/12 | | | 13 | | | | | | 2,650 | | |
| 70 | 95 | M 8 | 267 R/8 | 18 | 11,2 | 8,4 | 25 | 72 | 52 | 6 | 3 | 3,450 | 10 | |
| | | M 10 | 267 R/10 | | | 10,5 | | | | | | 3,800 | | |
| | | M 12 | 267 R/12 | | | 13 | | | | | | 3,350 | | |
| 95 | 120 | M 10 | 268 R/10 | 22 | 13,2 | 10,5 | 25 | 75 | 56 | 6 | 3 | 6,900 | 10 | |
| | | M 12 | 268 R/12 | | | 13 | | | | | | 4,920 | | |
| | | M 16 | 268 R/16** | | | 17 | | | | | | 6,000 | | |
| 120 | 150 | M 10 | 269 R/10 | 22 | 14,7 | 10,5 | 30 | 80 | 56 | 6 | 3 | 5,950 | 5 | |
| | | M 12 | 269 R/12 | | | 13 | | | | | | 5,840 | | |
| | | M 16 | 269 R/16 | | | 17 | | | | | | 6,600 | | |
| 150 | 185 | M 10 | 270 R/10 | 25 | 16,3 | 10,5 | 30 | 90 | 60 | 6 | 3 | 8,500 | 5 | |
| | | M 12 | 270 R/12 | | | 13 | | | | | | 7,730 | | |
| | | M 16 | 270 R/16 | | | 17 | | | | | | 7,600 | | |
| | | M 20 | 270 R/20** | | | 21 | | | | | | 8,200 | | |
| 185 | 240 | M 10 | 271 R/10 | 28 | 18,3 | 10,5 | 30 | 91 | 60 | 6 | 3 | 11,000 | 5 | |
| | | M 12 | 271 R/12 | | | 13 | | | | | | 9,880 | | |
| | | M 16 | 271 R/16 | | | 17 | | | | | | 10,100 | | |
| | | M 20 | 271 R/20** | | | 21 | | | | | | 10,000 | | |
| 240 | 300 | M 10 | 272 R/10** | 32 | 21 | 10,5 | 38 | 103 | 70 | 8 | 3 | 15,500 | 5 | |
| | | M 12 | 272 R/12 | | | 13 | | | | | | 13,800 | | |
| | | M 16 | 272 R/16 | | | 17 | | | | | | 13,480 | | |
| | | M 20 | 272 R/20 | | | 21 | | | | | | 15,000 | | |
| 300 | | M 12 | 273 R/12 | 34 | 23,3 | 13 | 38 | 103 | 70 | 8 | 3 | 17,600 | 1 | |
| | | M 16 | 273 R/16 | | | 17 | | | | | | 17,280 | | |
| | | M 20 | 273 R/20 | | | 21 | | | | | | 17,400 | | |
| 400 | | M 12 | 274 R/12 | 38 | 26 | 13 | 38 | 116 | 73 | - | 4 | 38,000 | 1 | |
| | | M 16 | 274 R/16 | | | 17 | | | | | | 37,400 | | |
| | | M 20 | 274 R/20 | | | 21 | | | | | | 40,200 | | |
| 500 | | M 12 | 275 R/12 | 44 | 29 | 13 | 44 | 122 | 79 | - | 4 | 43,700 | 1 | |
| | | M 16 | 275 R/16 | | | 17 | | | | | | 43,300 | | |
| | | M 20 | 275 R/20 | | | 21 | | | | | | 43,000 | | |

* pro pocínované provedení s dodatkem „v“.

** nenormalizováno

AL - LISOVACÍ KABELOVÁ OKA

pro hliníková lana podle DIN 48201

a zakulacené sektorové vodiče

materiál: AL 99,5

povrch: mechanicky leštěno

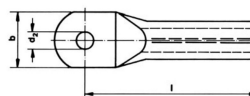
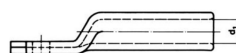

| jmenovitý průřez mm ² rm/sm | se | svorník Ø | obj. číslo | iden. číslo | rozměr mm | | | | počet slisování mech. hydr. | | nářadí | ⚖️ 100 ks ~ kg | 📦 balení ks | |
|--|------------|--------------|------------|----------------|----------------|----------------|--------|-----|-----------------------------------|---|-------------------------------------|----------------------|-------------------|----|
| | | | | | d ₁ | d ₂ | b | l | | | | | | |
| 10 | | M 6 | 202 R/6 | 10 | 5 | 6,5 | 16 | 52 | 4 | 2 | tabulka strana 3.17 - 3.18 | 0,860 | 100 | |
| | | M 8 | 202 R/8 | | | 8,5 | 18 | | | | | 0,880 | | |
| 16 | 25 | M 8 | 203 R/8 | 12 | 5,8 | 8,5 | 18 | 52 | 4 | 2 | | 1,370 | | 50 |
| | | M 10 | 203 R/10 | | | 10,5 | 1,390 | | | | | | | |
| 25 | 35 | M 8 | 204 R/8 | 12 | 6,8 | 8,5 | 18 | 60 | 4 | 2 | | 1,410 | | 50 |
| | | M 10 | 204 R/10 | | | 10,5 | 1,460 | | | | | | | |
| 35 | 50 | M 10 | 205 R/10 | 14 | 8 | 10,5 | 21 | 67 | 5 | 2 | | 2,080 | | 50 |
| | | M 12 | 205 R/12 | | | 13 | 2,050 | | | | | | | |
| 50 | 70 | M 10 | 206 R/10 | 16 | 9,8 | 10,5 | 25 | 72 | 5 | 2 | | 2,680 | | 50 |
| | | M 12 | 206 R/12 | | | 13 | 2,730 | | | | | | | |
| 70 | 95 | M 10 | 207 R/10 | 18 | 11,2 | 10,5 | 28 | 86 | 6 | 3 | | 4,420 | | 50 |
| | | M 12 | 207 R/12 | | | 13 | 4,270 | | | | | | | |
| 95 | 120 | M 10 | 208 R/10 | 22 | 13,2 | 10,5 | 32 | 90 | 6 | 3 | 7,400 | 25 | | |
| | | M 12 | 208 R/12 | | | 13 | 32 | | | | 7,500 | | | |
| | | M 16 | 208 R/16 | | | 17 | 34 | | | | 7,300 | | | |
| 120 | 150 | M 12 | 209 R/12 | 22 | 14,7 | 13 | 32 | 91 | 6 | 3 | 6,680 | 25 | | |
| | | M 16 | 209 R/16 | | | 17 | 34 | | | | 6,410 | | | |
| 150 | 185 | M 12 | 210 R/12 | 25 | 16,3 | 13 | 35 | 103 | 6 | 3 | 9,640 | 25 | | |
| | | M 16 | 210 R/16 | | | 17 | 35 | | | | 9,240 | | | |
| | | M 20 | 210 R/20 | | | 21 | 41 | | | | 9,400 | | | |
| 185 | 240 | M 12 | 211 R/12 | 28 | 18,3 | 13 | 40 | 106 | 6 | 3 | 12,610 | 5 | | |
| | | M 16 | 211 R/16 | | | 17 | 11,920 | | | | | | | |
| | | M 20 | 211 R/20 | | | 21 | 13,100 | | | | | | | |
| 240 | 300 | M 12 | 212 R/12 | 32 | 21 | 13 | 45 | 116 | 8 | 3 | 18,300 | 5 | | |
| | | M 16 | 212 R/16 | | | 17 | 17,600 | | | | | | | |
| | | M 20 | 212 R/20 | | | 21 | 17,300 | | | | | | | |
| 300 | | M 16 | 213 R/16 | 34 | 23,3 | 17 | 49 | 124 | 8 | 3 | 17,500 | 1 | | |
| | | M 20 | 213 R/20 | | | 21 | 17,300 | | | | | | | |
| 400 | | M 16 | 214 R/16 | 38 | 26 | 17 | 58 | 165 | — | 4 | 32,200 | 1 | | |
| | | M 20 | 214 R/20 | | | 21 | 31,900 | | | | | | | |



3



AL - LISOVACÍ KABELOVÁ OKA

pro Al / Fe lana podle DIN 48204

materiál: E - Al 99,5

povrch: mechanicky leštěno

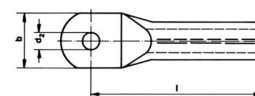
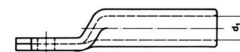

| jmenovitý průřez mm ² | svorník Ø | obj. číslo | iden. číslo | vodič Ø mm | rozměr mm | | | | nářadí | 100 ks ~ kg | balení ks |
|----------------------------------|--------------|------------|-------------|------------|----------------|----------------|----|-----|--|-------------|-----------|
| | | | | | d ₁ | d ₂ | b | l | | | |
| 25 - 4 | M 8 | 254 R/8 | 12 | 6,8 | 7,6 | 8,5 | 19 | 60 | tabulka strana 3.17 - 3.18 | 1,500 | 5 |
| | M 10 | 254 R/10 | | | | 10,5 | 19 | | | | |
| | M 12 | 254 R/12 | | | | 13 | 23 | | | | |
| 35 - 6 | M 10 | 255 R/10 | 14 | 8,1 | 9 | 10,5 | 21 | 67 | | 2,000 | 5 |
| | M 12 | 255 R/12 | | | | 13 | 21 | | | | |
| 50 - 8 | M 10 | 256 R/10 | 16 | 9,6 | 10,8 | 10,5 | 22 | 72 | | 2,500 | 5 |
| | M 12 | 256 R/12 | | | | 13 | 24 | | | | |
| | M 16 | 256 R/16 | | | | 17 | 26 | | | | |
| 70 - 12 | M 10 | 257 R/10 | 18 | 11,7 | 12,5 | 10,5 | 26 | 86 | | 4,100 | 5 |
| | M 12 | 257 R/12 | | | | 13 | 26 | | | | |
| | M 16 | 257 R/16 | | | | 17 | 32 | | | | |
| 95 - 15 | M 12 | 258 R/12 | 22 | 13,6 | 14,8 | 13 | 31 | 91 | | 7,800 | 5 |
| | M 16 | 258 R/16 | | | | 17 | 33 | | | | |
| 120 - 20 | M 12 | 259 R/12 | 25 | 15,5 | 16,5 | 13 | 37 | 103 | tabulka strana 3.17 - 3.18 jako lisovací spojky pevné v tahu | 9,800 | 5 |
| | M 16 | 259 R/16 | | | | 17 | 37 | | | | |
| | M 20 | 259 R/20 | | | | 21 | 41 | | | | |

3

CUPAL - PODLOŽKY

Materiál: Al 99,5, jednostranně poměděno

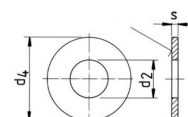

| Závit Ø | obj. číslo | rozměr mm | | | 100 ks ~ kg | balení ks |
|-------------|------------|----------------|----------------|---|-------------|-----------|
| | | d ₄ | d ₂ | s | | |
| M 8 | CS 8 - 18 | 18 | 8,5 | 1 | 0,090 | 50 |
| M 10 | CS 10 - 22 | 22 | 11 | 2 | 0,260 | 50 |
| M 12 | CS 12 - 28 | 28 | 13 | 2 | 0,440 | 50 |
| M 14 | CS 14 - 28 | 28 | 15 | 2 | 0,400 | 50 |
| M 16 | CS 16 - 35 | 35 | 17 | 2 | 0,660 | 50 |

AL - CU - LISOVACÍ KABELOVÁ OKA

pro hliníková lana podle DIN 48201
a zakulacené sektorové vodiče, přechod z Al na Cu
plná, uzavřená s masivním Cu - přechodem
materiál: Al 99,5 ; E - Cu
povrch: mechanicky leštěno

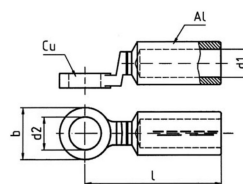

| jmenovitý průřez mm ² rm/sm | svorník se Ø | obj. číslo | iden. číslo | rozměr mm | | | | počet slisování mech. hydr. | | nářadí | 100 ks ~ kg | | balení ks |
|--|--------------------|------------|----------------|----------------|----------------|------|----|-----------------------------------|--------|--------|-------------|--------|--------------|
| | | | | d ₁ | d ₂ | b | l | Cu | celkem | | | | |
| 16 | 25 | M 8 | 363 R/8 | 12 | 6 | 8,5 | 25 | 67,5 | 4 | 2 | 4,400 | 5,900 | 10 |
| | | M 10 | 363 R/10 | | | 10,5 | | | | | 4,200 | 5,700 | |
| 25 | 35 | M 8 | 364 R/8 | 12 | 6,8 | 8,5 | 25 | 67,5 | 4 | 2 | 4,400 | 5,800 | 10 |
| | | M 10 | 364 R/10 | | | 10,5 | | | | | 4,200 | 5,600 | |
| | | M 12 | 364 R/12 | | | 13 | | | | | 3,900 | 5,300 | |
| 35 | 50 | M 8 | 365 R/8 | 14 | 8 | 8,5 | 25 | 76,5 | 5 | 2 | 4,400 | 6,300 | 10 |
| | | M 10 | 365 R/10 | | | 10,5 | | | | | 4,200 | 6,100 | |
| | | M 12 | 365 R/12 | | | 13 | | | | | 3,800 | 5,800 | |
| 50 | 70 | M 8 | 366 R/8 | 16 | 9,8 | 8,5 | 25 | 76,5 | 5 | 2 | 4,400 | 6,400 | 10 |
| | | M 10 | 366 R/10 | | | 10,5 | | | | | 4,200 | 6,200 | |
| | | M 12 | 366 R/12 | | | 13 | | | | | 3,900 | 5,900 | |
| 70 | 95 | M 10 | 367 R/10 | 18 | 11,2 | 10,5 | 25 | 84,5 | 6 | 3 | 4,200 | 7,400 | 10 |
| | | M 12 | 367 R/12 | | | 13 | | | | | 3,900 | 7,100 | |
| 95 | 120 | M 10 | 368 R/10 | 22 | 13,2 | 10,5 | 30 | 90,5 | 6 | 3 | 7,400 | 11,400 | 10 |
| | | M 12 | 368 R/12 | | | 13 | | | | | 6,800 | 10,800 | |
| | | M 16 | 368 R/16 | | | 17 | | | | | 6,400 | 10,400 | |
| 120 | 150 | M 12 | 369 R/12 | 22 | 14,7 | 13 | 30 | 92 | 6 | 3 | 6,800 | 11,400 | 5 |
| | | M 16 | 369 R/16 | | | 17 | | | | | 6,400 | 10,800 | |
| 150 | 185 | M 12 | 370 R/12 | 25 | 16,3 | 13 | 30 | 104 | 6 | 3 | 6,800 | 13,100 | 5 |
| | | M 16 | 370 R/16 | | | 17 | | | | | 6,400 | 12,700 | |
| | | M 20 | 370 R/20 | | | 21 | | | | | 10,100 | 16,400 | |
| 185 | 240 | M 10 | 371 R/10 | 28 | 18,3 | 10,5 | 30 | 105 | 6 | 3 | 10,300 | 18,600 | 5 |
| | | M 12 | 371 R/12 | | | 13 | | | | | 10,100 | 18,400 | |
| | | M 16 | 371 R/16 | | | 17 | | | | | 9,300 | 17,600 | |
| | | M 20 | 371 R/20 | | | 21 | | | | | 10,100 | 18,400 | |
| 240 | 300 | M 10 | 372 R/10 | 32 | 21 | 10,5 | 35 | 118,5 | 8 | 3 | 12,100 | 22,500 | 5 |
| | | M 12 | 372 R/12 | | | 13 | | | | | 11,800 | 22,200 | |
| | | M 16 | 372 R/16 | | | 17 | | | | | 11,000 | 21,400 | |
| | | M 20 | 372 R/20 | | | 21 | | | | | 10,100 | 20,500 | |
| 300 | | M 12 | 373 R/12 | 34 | 23,3 | 13 | 40 | 123,5 | 8 | 3 | 17,700 | 33,700 | 1 |
| | | M 16 | 373 R/16 | | | 17 | | | | | 16,900 | 32,900 | |
| | | M 20 | 373 R/20 | | | 21 | | | | | 16,000 | 32,000 | |



AL - CU - LISOVACÍ KABELOVÁ OKA

pro hliníková lana podle DIN 48201

a zakulacené sektorové vodiče

materiál: Al 99,5 ; E - Cu

povrch: mechanicky lešteno

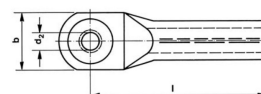
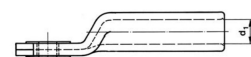

| jmenovitý průřez mm ² rm/sm | svorník se | svorník Ø | obj. číslo | iden. číslo | rozměr mm | | | | počet slisování mech. hydr. | | nářadí | 100 ks ~ kg | | balení ks |
|--|---------------|--------------|------------|----------------|----------------|----------------|----|-----|-----------------------------------|--------|-------------------------------------|-------------|-------|--------------|
| | | | | | d ₁ | d ₂ | b | l | Cu | celkem | | | | |
| 10 | | M 6 | 302 R/6 | 10 | 5 | 6,5 | 18 | 52 | 4 | 2 | tabulka strana 3.17 - 3.18 | 0,260 | 1,200 | 10 |
| | | M 8 | 302 R/8 | | | 8,5 | 22 | | | | | 0,580 | 1,500 | |
| 16 | 25 | M 8 | 303 R/8 | 12 | 5,8 | 8,5 | 22 | 52 | 4 | 2 | | 0,600 | 1,950 | 10 |
| | | M 10 | 303 R/10 | | | 10,5 | 25 | | | | | 0,600 | 2,000 | |
| 25 | 35 | M 8 | 304 R/8 | 12 | 6,8 | 8,5 | 22 | 60 | 4 | 2 | | 0,625 | 2,000 | 10 |
| | | M 10 | 304 R/10 | | | 10,5 | 25 | | | | | 0,900 | 2,100 | |
| 35 | 50 | M 10 | 305 R/10 | 14 | 8 | 10,5 | 26 | 67 | 5 | 2 | | 0,900 | 3,000 | 10 |
| | | M 12 | 305 R/12 | | | 13 | 30 | | | | | 1,120 | 3,100 | |
| 50 | 70 | M 10 | 306 R/10 | 16 | 9,8 | 10,5 | 27 | 72 | 5 | 2 | | 0,900 | 3,600 | 10 |
| | | M 12 | 306 R/12 | | | 13 | 30 | | | | | 1,120 | 3,800 | |
| 70 | 95 | M 10 | 307 R/10 | 18 | 11,2 | 10,5 | 29 | 86 | 6 | 3 | 1,075 | 5,600 | 10 | |
| | | M 12 | 307 R/12 | | | 13 | 32 | | | | 1,300 | 5,700 | | |
| 95 | 120 | M 10 | 308 R/10 | 22 | 13,2 | 10,5 | 32 | 90 | 6 | 3 | 1,435 | 10,000 | 5 | |
| | | M 12 | 308 R/12 | | | 13 | 35 | | | | 1,735 | 9,500 | | |
| | | M 16 | 308 R/16 | | | 17 | 38 | | | | 2,655 | 10,000 | | |
| 120 | 150 | M 12 | 309 R/12 | 22 | 14,7 | 13 | 35 | 91 | 6 | 3 | 1,810 | 8,700 | 5 | |
| | | M 16 | 309 R/16 | | | 17 | 38 | | | | 2,230 | 8,800 | | |
| 150 | 185 | M 12 | 310 R/12 | 25 | 16,3 | 13 | 35 | 103 | 6 | 3 | 2,025 | 12,200 | 5 | |
| | | M 16 | 310 R/16 | | | 17 | 41 | | | | 2,655 | 12,300 | | |
| | | M 20 | 310 R/20 | | | 21 | 44 | | | | 3,620 | 12,800 | | |
| 185 | 240 | M 12 | 311 R/12 | 28 | 18,3 | 13 | 40 | 106 | 6 | 3 | 2,320 | 15,000 | 5 | |
| | | M 16 | 311 R/16 | | | 17 | 42 | | | | 4,975 | 15,500 | | |
| | | M 20 | 311 R/20 | | | 21 | 46 | | | | 4,610 | 15,500 | | |
| 240 | 300 | M 12 | 312 R/12 | 32 | 21 | 13 | 45 | 116 | 8 | 3 | 2,750 | 20,000 | 5 | |
| | | M 16 | 312 R/16 | | | 17 | 45 | | | | 3,400 | 21,000 | | |
| | | M 20 | 312 R/20 | | | 21 | 49 | | | | 4,600 | 22,000 | | |
| 300 | | M 16 | 313 R/16 | 34 | 23,3 | 17 | 51 | 124 | 8 | 3 | 3,980 | 21,600 | 1 | |
| | | M 20 | 313 R/20 | | | 21 | 51 | | | | 5,510 | 22,200 | | |
| 400 | | M 16 | 314 R/16 | 38 | 26 | 17 | 58 | 165 | - | 4 | 4,200 | 35,000 | 1 | |
| | | M 20 | 314 R/20 | | | 21 | 58 | | | | 5,950 | 35,000 | | |

AL - LISOVACÍ SPOJKY

DIN 46267, část 2, pro spojení nenamáhané v tahu
 pro hliníkové vodiče podle DIN 48201
 a zakulacené sektorové vodiče
 materiál: Al 99,5 ; povrch: mechanicky leštěno

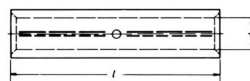

| jmenovitý průřez mm ² rm/sm se | | obj. číslo | iden. číslo | rozměr mm d ₁ l | | počet slisování mech. hydr. | | nářadí | 100 ks ~ kg | balení ks |
|---|------------|------------|----------------|-------------------------------|-----|-----------------------------------|-----|-------------------------------------|----------------|--------------|
| 10 | | 222 R* | 10 | 5 | 55 | 3/3 | – | tabulka strana 3.17 - 3.18 | 0,950 | 50 |
| 16 | 25 | 223 R* | 12 | 5,8 | 55 | 3/3 | – | | 1,400 | 50 |
| 25 | 35 | 224 R | 12 | 6,8 | 70 | 4/4 | 2/2 | | 1,600 | 50 |
| 35 | 50 | 225 R | 14 | 8 | 85 | 5/5 | 2/2 | | 2,600 | 50 |
| 50 | 70 | 226 R | 16 | 9,8 | 85 | 5/5 | 2/2 | | 3,200 | 50 |
| 70 | 95 | 227 R | 18 | 11,2 | 105 | 6/6 | 3/3 | | 5,300 | 25 |
| 95 | 120 | 228 R | 22 | 13,2 | 105 | 6/6 | 3/3 | | 7,600 | 25 |
| 120 | 150 | 229 R | 22 | 14,7 | 105 | 6/6 | 3/3 | | 7,800 | 25 |
| 150 | 185 | 230 R | 25 | 16,3 | 125 | 6/6 | 3/3 | | 10,700 | 25 |
| 185 | 240 | 231 R | 28 | 18,3 | 125 | 6/6 | 3/3 | | 14,300 | 5 |
| 240 | 300 | 232 R | 32 | 21 | 145 | 8/8 | 3/3 | | 20,300 | 5 |
| 300 | | 233 R | 34 | 23,3 | 145 | 8/8 | 3/3 | | 22,200 | 1 |
| 400 | | 234 R | 38 | 26 | 210 | – | 5/5 | | 40,800 | 1 |
| 500 | | 235 R | 44 | 29 | 210 | – | 5/5 | 56,000 | 1 | |



AL - LISOVACÍ SPOJKY

pro spojení nenamáhané v tahu
 Al - vysokonapěťových kabelů od 10 - 30 kV
 materiál: AL 99,5 ; povrch: mechanicky leštěno



| jmenovitý průřez mm ² rm/sm se | | obj. číslo | iden. číslo | rozměr mm d ₁ l | | počet slisování mech. hydr. | | nářadí | 100 ks ~ kg | balení ks |
|---|------------|------------|----------------|-------------------------------|-----|-----------------------------------|-----|-------------------------------------|----------------|--------------|
| 35 | 50 | 405 R | 14 | 8,2 | 90 | 4/4 | 2/2 | tabulka strana 3.17 - 3.18 | 2,700 | 10 |
| 50 | 70 | 406 R | 16 | 10 | 90 | 4/4 | 2/2 | | 3,400 | 10 |
| 70 | 95 | 407 R | 18 | 11,5 | 95 | 4/4 | 2/2 | | 4,600 | 10 |
| 95 | 120 | 408 R | 22 | 13,5 | 100 | 4/4 | 2/2 | | 6,800 | 10 |
| 120 | 150 | 409 R | 22 | 15 | 105 | 4/4 | 2/2 | | 7,400 | 10 |
| 150 | 185 | 410 R | 25 | 16,5 | 105 | 4/4 | 2/2 | | 8,700 | 10 |
| 185 | 240 | 411 R | 28 | 18,5 | 125 | 5/5 | 2/2 | | 13,400 | 5 |
| 240 | 300 | 412 R | 32 | 21,3 | 125 | 5/5 | 2/2 | | 15,700 | 5 |
| 300 | | 413 R | 34 | 23,6 | 125 | 5/5 | 2/2 | | 16,300 | 1 |
| 400 | | 414 R | 38 | 26,25 | 150 | – | 3/3 | 25,800 | 1 | |





AL - LISOVACÍ SPOJKY

pro spojení nenamáhané v tahu

Al - vysokonapěťových kabelů od 10 - 30 kV

materiál: AL 99,5

povrch: mechanicky leštěno

střední příčkou se dosáhne úplné nepropustnosti oleje

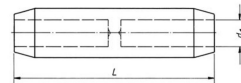

| jmenovitý průřez mm ² rm/sm se | | obj. číslo | iden. číslo | rozměr mm | | | počet sřisování | | nářadí | 100 ks ~ kg | balení ks |
|---|------------|------------|-------------|----------------|-----|--|-----------------|-------|-------------------------------------|----------------|--------------|
| | | | | d ₁ | l | | mech. | hydr. | | | |
| 35 | 50 | 415 R | 14 | 8 | 95 | | 4/4 | 2/2 | tabulka strana 3.17 - 3.18 | 2,200 | 10 |
| 50 | 70 | 416 R | 16 | 9,8 | 95 | | 4/4 | 2/2 | | 5,600 | 10 |
| 70 | 95 | 417 R | 18 | 11,2 | 100 | | 4/4 | 2/2 | | 6,100 | 10 |
| 95 | 120 | 418 R | 22 | 13,2 | 105 | | 4/4 | 2/2 | | 9,200 | 10 |
| 120 | 150 | 419 R | 22 | 14,7 | 110 | | 4/4 | 2/2 | | 10,300 | 10 |
| 150 | 185 | 420 R | 25 | 16,3 | 110 | | 4/4 | 2/2 | | 12,000 | 10 |
| 185 | 240 | 421 R | 28 | 18,3 | 130 | | 5/5 | 2/2 | | 15,600 | 5 |
| 240 | 300 | 422 R | 32 | 21 | 130 | | 5/5 | 2/2 | | 19,100 | 5 |
| 300 | | 423 R | 34 | 23,3 | 135 | | 5/5 | 2/2 | | 30,700 | 1 |
| 400 | | 424 R | 38 | 26 | 165 | | - | 3/3 | | 30,000 | 1 |

3

AL - REDUKČNÍ LISOVACÍ SPOJKY

pro spojení nenamáhané v tahu

pro vysokonapěťové kabely od 10 - 30 kV

materiál: AL 99,5

povrch: mechanicky leštěno

střední příčkou se dosáhne úplné nepropustnosti oleje

nabízené jmenovité průřezy se vztahují na rm / sm - vodiče

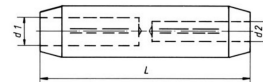

| jmenovitý průřez mm ² z na | | obj. číslo | iden. číslo | rozměr mm | | | počet sřisování | | nářadí | 100 ks ~ kg | balení ks |
|---|-----------|------------|-------------|----------------|----------------|-----|-----------------|-------|----------------------------------|----------------|--------------|
| | | | | d ₁ | d ₂ | l | mech. | hydr. | | | |
| 35 | 25 | 425 R/25 | 14 | 8 | 6,8 | 95 | 4/4 | 2/2 | tabulka strana 3.17 - 3.18 | 2,800 | 10 |
| 50 | 25 | 426 R/25 | 16 | 9,8 | 6,8 | 95 | 4/4 | 2/2 | | 3,630 | 10 |
| 50 | 35 | 426 R/35 | 16 | 9,8 | 8 | 95 | 4/4 | 2/2 | | 3,450 | 10 |
| 70 | 25 | 427 R/25 | 18 | 11,2 | 6,8 | 100 | 4/4 | 2/2 | | 4,975 | 10 |
| 70 | 35 | 427 R/35 | 18 | 11,2 | 8 | 100 | 4/4 | 2/2 | | 4,790 | 10 |
| 70 | 50 | 427 R/50 | 18 | 11,2 | 9,8 | 100 | 4/4 | 2/2 | | 4,420 | 10 |
| 95 | 25 | 428 R/25 | 22 | 13,2 | 6,8 | 105 | 4/4 | 2/2 | | 8,200 | 10 |
| 95 | 35 | 428 R/35 | 22 | 13,2 | 8 | 105 | 4/4 | 2/2 | | 8,000 | 10 |
| 95 | 50 | 428 R/50 | 22 | 13,2 | 9,8 | 105 | 4/4 | 2/2 | | 7,600 | 10 |
| 95 | 70 | 428 R/70 | 22 | 13,2 | 11,2 | 105 | 4/4 | 2/2 | | 7,350 | 10 |

AL - REDUKČNÍ LISOVACÍ SPOJKY

pro spojení nenamáhané v tahu

pro Al - vysokonapěťové kabely od 10 - 30 kV

materiál: Al 99,5

povrch: mechanicky leštěno

střední příčkou se dosáhne úplné nepropustnosti oleje

nabízené jmenovité průřezy se vztahují na rm / sm - vodiče

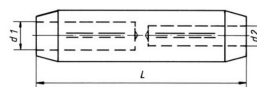

| jmenovitý průřez mm ² | | obj. číslo | iden. číslo | rozměr mm | | | počet slisování | | nářadí | 100 ks ~ kg | balení ks |
|-------------------------------------|------------|------------|----------------|----------------|----------------|-----|--------------------|-------|----------------------------------|----------------|--------------|
| z | na | | | d ₁ | d ₂ | l | mech. | hydr. | | | |
| 120 | 25 | 429 R/25 | 22 | 14,7 | 6,8 | 110 | 4/4 | 2/2 | tabulka strana 3.17 - 3.18 | 8,000 | 10 |
| 120 | 35 | 429 R/35 | 22 | 14,7 | 8 | 110 | 4/4 | 2/2 | | 7,800 | |
| 120 | 50 | 429 R/50 | 22 | 14,7 | 9,8 | 110 | 4/4 | 2/2 | | 7,380 | |
| 120 | 70 | 429 R/70 | 22 | 14,7 | 11,2 | 110 | 4/4 | 2/2 | | 7,100 | |
| 120 | 95 | 429 R/95 | 22 | 14,7 | 13,2 | 110 | 4/4 | 2/2 | | 6,550 | |
| 150 | 25 | 430 R/25 | 25 | 16,3 | 6,8 | 110 | 4/4 | 2/2 | 10,700 | 10 | |
| 150 | 35 | 430 R/35 | 25 | 16,3 | 8 | 110 | 4/4 | 2/2 | 10,500 | | |
| 150 | 50 | 430 R/50 | 25 | 16,3 | 9,8 | 110 | 4/4 | 2/2 | 10,100 | | |
| 150 | 70 | 430 R/70 | 25 | 16,3 | 11,2 | 110 | 4/4 | 2/2 | 9,800 | | |
| 150 | 95 | 430 R/95 | 25 | 16,3 | 13,2 | 110 | 4/4 | 2/2 | 9,500 | | |
| 150 | 120 | 430 R/120 | 25 | 16,3 | 14,7 | 110 | 4/4 | 2/2 | 8,650 | | |
| 185 | 25 | 431 R/25 | 28 | 18,3 | 6,8 | 130 | - | 2/2 | 16,120 | 5 | |
| 185 | 35 | 431 R/35 | 28 | 18,3 | 8 | 130 | - | 2/2 | 15,875 | | |
| 185 | 50 | 431 R/50 | 28 | 18,3 | 9,8 | 130 | - | 2/2 | 15,400 | | |
| 185 | 70 | 431 R/70 | 28 | 18,3 | 11,2 | 130 | - | 2/2 | 15,050 | | |
| 185 | 95 | 431 R/95 | 28 | 18,3 | 13,2 | 130 | - | 2/2 | 14,400 | | |
| 185 | 120 | 431 R/120 | 28 | 18,3 | 14,7 | 130 | 5/5 | 2/2 | 13,700 | | |
| 185 | 150 | 431 R/150 | 28 | 18,3 | 16,3 | 130 | 5/5 | 2/2 | 13,050 | | |
| 240 | 25 | 432 R/25 | 32 | 21 | 6,8 | 130 | - | 2/2 | 21,200 | 5 | |
| 240 | 35 | 432 R/35 | 32 | 21 | 8 | 130 | - | 2/2 | 20,950 | | |
| 240 | 50 | 432 R/50 | 32 | 21 | 9,8 | 130 | - | 2/2 | 20,470 | | |
| 240 | 70 | 432 R/70 | 32 | 21 | 11,2 | 130 | - | 2/2 | 20,120 | | |
| 240 | 95 | 432 R/95 | 32 | 21 | 13,2 | 130 | - | 2/2 | 19,460 | | |
| 240 | 120 | 432 R/120 | 32 | 21 | 14,7 | 130 | - | 2/2 | 18,800 | | |
| 240 | 150 | 432 R/150 | 32 | 21 | 16,3 | 130 | 5/5 | 2/2 | 18,125 | | |
| 240 | 185 | 432 R/185 | 32 | 21 | 18,3 | 130 | 5/5 | 2/2 | 17,275 | | |
| 300 | 150 | 433 R/150 | 34 | 23,3 | 16,3 | 135 | 5/5 | 2/2 | 21,100 | 1 | |
| 300 | 185 | 433 R/185 | 34 | 23,3 | 18,3 | 135 | 5/5 | 2/2 | 20,120 | | |
| 300 | 240 | 433 R/240 | 34 | 23,3 | 21 | 135 | 5/5 | 2/2 | 18,730 | | |
| 400 | 185 | 434 R/185 | 38 | 26 | 18,3 | 165 | - | 3/3 | 34,700 | 1 | |
| 400 | 240 | 434 R/240 | 38 | 26 | 21 | 165 | - | 3/3 | 32,900 | | |
| 400 | 300 | 434 R/300 | 38 | 26 | 23,3 | 165 | - | 3/3 | 31,200 | | |



AL - REDUKČNÍ LISOVACÍ SPOJKY

pro spojení nenamáhané v tahu
 pro hliníkové vodiče podle DIN 48201
 a zakulacené sektorové vodiče
 materiál: Al 99,5 ; povrch: mechanicky leštěno



nabízené jmenovité průřezy se vztahují na **rm / sm - vodiče**



| jmenovitý průřez mm ² | | obj. číslo | iden. číslo | rozměr mm | | | počet slisování | | nářadí | 100 ks ~ kg | balení ks |
|-------------------------------------|------------|------------|----------------|----------------|----------------|-----|--------------------|-------|----------------------------------|----------------|--------------|
| z | na | | | d ₁ | d ₂ | l | mech. | hydr. | | | |
| 25 | 16 | 284 R/16 | 12 | 7 | 5,8 | 75 | 4/4 | 2/2 | tabulka strana 3.17 - 3.18 | 1,530 | 10 |
| 35 | 25 | 285 R/25 | 14 | 8,2 | 6,8 | 90 | 5/5 | 2/2 | | 2,500 | 10 |
| 50 | 25 | 286 R/25 | 16 | 10 | 6,8 | 90 | 5/5 | 2/2 | 3,240 | 10 | |
| 50 | 35 | 286 R/35 | 16 | 10 | 8 | 90 | 5/5 | 2/2 | | | 3,090 |
| 70 | 25 | 287 R/25 | 18 | 11,5 | 6,8 | 110 | 6/6 | 3/3 | 5,500 | 10 | |
| 70 | 35 | 287 R/35 | 18 | 11,5 | 8 | 110 | 6/6 | 3/3 | | | 5,350 |
| 70 | 50 | 287 R/50 | 18 | 11,5 | 9,8 | 110 | 6/6 | 3/3 | | | 4,960 |
| 95 | 25 | 288 R/25 | 22 | 13,5 | 6,8 | 110 | 6/6 | 3/3 | 9,100 | 10 | |
| 95 | 35 | 288 R/35 | 22 | 13,5 | 8 | 110 | 6/6 | 3/3 | | | 8,900 |
| 95 | 50 | 288 R/50 | 22 | 13,5 | 9,8 | 110 | 6/6 | 3/3 | | | 8,510 |
| 95 | 70 | 288 R/70 | 22 | 13,5 | 11,2 | 110 | 6/6 | 3/3 | | | 8,150 |
| 120 | 25 | 289 R/25 | 22 | 15 | 6,8 | 110 | 6/6 | 3/3 | 8,620 | 10 | |
| 120 | 35 | 289 R/35 | 22 | 15 | 8 | 110 | 6/6 | 3/3 | | | 8,430 |
| 120 | 50 | 289 R/50 | 22 | 15 | 9,8 | 110 | 6/6 | 3/3 | | | 8,040 |
| 120 | 70 | 289 R/70 | 22 | 15 | 11,2 | 110 | 6/6 | 3/3 | | | 7,660 |
| 120 | 95 | 289 R/95 | 22 | 15 | 13,2 | 110 | 6/6 | 3/3 | | | 7,140 |
| 150 | 35 | 290 R/35 | 25 | 16,5 | 8 | 130 | 6/6 | 3/3 | 12,590 | 10 | |
| 150 | 50 | 290 R/50 | 25 | 16,5 | 9,8 | 130 | 6/6 | 3/3 | | | 12,120 |
| 150 | 70 | 290 R/70 | 25 | 16,5 | 11,2 | 130 | 6/6 | 3/3 | | | 11,700 |
| 150 | 95 | 290 R/95 | 25 | 16,5 | 13,2 | 130 | 6/6 | 3/3 | | | 11,050 |
| 150 | 120 | 290 R/120 | 25 | 16,5 | 14,7 | 130 | 6/6 | 3/3 | | | 10,490 |
| 185 | 120 | 291 R/120 | 28 | 18,5 | 14,7 | 130 | 6/6 | 3/3 | 13,800 | 5 | |
| 185 | 150 | 291 R/150 | 28 | 18,5 | 16,3 | 130 | 6/6 | 3/3 | | | 13,190 |
| 240 | 95 | 292 R/ 95 | 32 | 21,3 | 13,2 | 150 | - | 3/3 | 22,240 | 5 | |
| 240 | 120 | 292 R/120 | 32 | 21,3 | 14,7 | 150 | - | 3/3 | | | 21,590 |
| 240 | 150 | 292 R/150 | 32 | 21,3 | 16,3 | 150 | - | 3/3 | | | 20,870 |

AL - LISOVACÍ SPOJKY DIN 48085, ČÁST 2

pro spojení namáhané v tahu
 hliníkových vodičů podle DIN 48201, list 5 a sektorových vodičů
 materiál: Al 99,5 do 95 mm², AlMgSi 1m do 120 mm²
 povrch: mechanicky leštěno

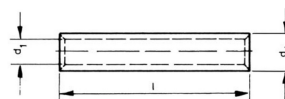

| jmenovitý průřez mm ² | obj. číslo | iden. číslo | vodič Ø | rozměr mm | | | počet slisování | | nářadí | 100 ks ~ kg | balení ks |
|----------------------------------|------------|-------------|------------|----------------|----------------|-----|-----------------|-------|----------------------------|-------------|-----------|
| | | | | d ₁ | d ₄ | l | mech. | hydr. | | | |
| 16 | 243 R* | 12 | 5,1 | 5,8 | 12 | 140 | 8/8 | 4/4 | tabulka strana 3.17 - 3.18 | 3,400 | 10 |
| 25 | 244 R | 12 | 6,3 | 6,8 | 12 | 140 | 8/8 | 4/4 | | 2,900 | 10 |
| 35 | 245 R | 14 | 7,5 | 8 | 14 | 140 | 8/8 | 4/4 | | 3,900 | 10 |
| 50 | 246 R | 16 | 9 | 10 | 16 | 155 | 8/8 | 4/4 | | 5,200 | 10 |
| 70 | 247 R | 18 | 10,5 | 11,5 | 18,5 | 165 | 8/8 | 4/4 | | 7,400 | 10 |
| 95 | 248 R | 22 | 12,5 | 13,5 | 22 | 165 | 8/8 | 4/4 | | 12,200 | 10 |
| 120 | 249 R | 25 | 14 | 15,5 | 25,5 | 250 | 12/12 | 6/6 | | 21,800 | 10 |
| 150 | 250 R | 28 | 15,7 | 16,5 | 28,5 | 300 | - | 7/7 | | 34,400 | 10 |
| 185 | 251 R | 28 | 17,5 | 18,5 | 28,5 | 330 | - | 7/7 | | 33,000 | 5 |
| 240 | 252 R | 34 | 20,2 | 21,5 | 34,5 | 350 | - | 7/7 | | 54,000 | 5 |
| 300 | 253 R | 38 | 22,5 | 23,5 | 38,5 | 400 | - | 8/8 | 79,000 | 1 | |

* nenormalizováno

LISOVACÍ SPOJKY

pro spojení namáhané v tahu
 Aldrey - lan podle DIN 48201, list 6
 materiál: AlMgSi F 20
 povrch: mechanicky leštěno



| jmenovitý průřez mm ² | obj. číslo | iden. číslo | vodič Ø | rozměr mm | | počet slisování | | nářadí | 100 ks ~ kg | balení ks |
|----------------------------------|------------|-------------|------------|----------------|-----|-----------------|-------|----------------------------|-------------|-----------|
| | | | | d ₁ | l | mech. | hydr. | | | |
| 25 | 294 AD | 12 | 6,3 | 6,8 | 140 | 8/8 | - | tabulka strana 3.17 - 3.18 | 3,400 | 5 |
| 35 | 295 AD | 14 | 7,5 | 8 | 140 | 8/8 | - | | 4,700 | 5 |
| 50 | 296 AD | 16 | 9 | 10 | 155 | 8/8 | - | | 5,900 | 5 |
| 70 | 297 AD | 18 | 10,5 | 11,5 | 165 | 8/8 | - | | 9,000 | 5 |
| 95 | 298 AD | 20 | 12,5 | 13,5 | 165 | 10/10 | 5/5 | | 10,200 | 5 |



LISOVACÍ SPOJKY

pro spojení nenamáhané v tahu
Al / Fe - lana podle DIN 48204
materiál: Al 99,5
povrch: mechanicky leštěno



| jmenovitý průřez mm ² | obj. číslo | iden. číslo | vodič Ø | rozměr mm | | počet slisování | | nářadí | 100 ks ~ kg | balení ks |
|----------------------------------|------------|-------------|---------|----------------|-----|-----------------|-------|----------------------------|-------------|-----------|
| | | | | d ₁ | l | mech. | hydr. | | | |
| 25 - 4 | 444 R | 12 | 6,8 | 7,6 | 70 | 4/4 | 2/2 | tabulka strana 3.17 - 3.18 | 1,650 | 5 |
| 35 - 6 | 445 R | 14 | 8,1 | 9 | 85 | 5/5 | 2/2 | | 2,750 | 5 |
| 50 - 8 | 446 R | 16 | 9,6 | 10,8 | 85 | 5/5 | 2/2 | | 3,700 | 5 |
| 70 - 12 | 447 R | 18 | 11,7 | 12,5 | 105 | 6/6 | 3/3 | | 5,200 | 5 |
| 95 - 15 | 448 R | 22 | 13,6 | 14,8 | 105 | 6/6 | 3/3 | | 8,600 | 5 |
| 120 - 20 | 449 R | 25 | 15,5 | 16,5 | 125 | 6/6 | 3/3 | | 12,200 | 5 |

3

LISOVACÍ SPOJKY DIN 48085, ČÁST 3

pro spojení namáhané v tahu
Al / Fe - lana podle DIN 48204
materiál Al / spojky: Al 99,5
povrch Al / spojky: mechanicky leštěno
materiál ocelových spojek: ocel 52
povrch ocelových spojek: žárově zinkováno

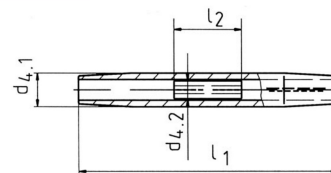

| jmenovitý průřez mm ² | obj. číslo | vodič Ø | Al | | | | Fe | | | | nářadí | 100 ks ~ kg | balení ks | | |
|----------------------------------|------------|---------|-------------|----------------------------|----------------|-----------------------------|-------------|----------------------------|----------------|-----------------------------|--------|-------------|----------------------------|--------|---|
| | | | iden. číslo | rozměr mm d _{4,1} | l ₁ | počet slisování mech. hydr. | iden. číslo | rozměr mm d _{4,2} | l ₂ | počet slisování mech. hydr. | | | | | |
| 25 - 4 | 454 R | 6,8 | 12 | 12 | 200 | 7/ 7 | - | 6 | 6,3 | 65 | 4/4 | - | tabulka strana 3.17 - 3.18 | 5,000 | 5 |
| 35 - 6 | 455 R | 8,1 | 14 | 14 | 235 | 8/ 8 | - | 6 | 6,3 | 75 | 5/5 | - | | 7,000 | 5 |
| 50 - 8 | 456 R | 9,6 | 16 | 16 | 270 | 9/ 9 | - | 7 | 7,5 | 95 | 6/6 | - | | 11,000 | 5 |
| 70 - 12 | 457 R | 11,7 | 18 | 18,5 | 270 | 9/ 9 | - | 9 | 9,5 | 95 | 6/6 | - | | 15,000 | 5 |
| 95 - 15 | 458 R | 13,6 | 22 | 22,5 | 310 | 11/11 | - | 9 | 9,6 | 95 | 6/6 | - | | 23,000 | 5 |
| 120 - 20 | 459 R | 15,5 | 25 | 25 | 380 | 13/13 | 6/6 | 13 | 13 | 110 | 7/7 | 4/4 | | 36,000 | 5 |

AL - LISOVACÍ SPOJKY

S CU - ČEPEM

materiál: AL 99,5 ; E - Cu
povrch: mechanicky leštěno

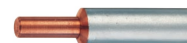
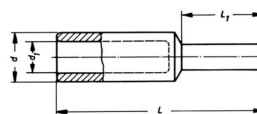

| jmenovitý průřez mm ² rm/sm | | obj. číslo | Ø mm kolík | vodič | iden. číslo | rozměr mm | | | | nářadí | 100 ks ~ kg Cu celkem | balení ks | |
|--|------------|------------|------------------|-------|----------------|-----------|------------------|----------------|-----|----------------------------------|--------------------------|--------------|----|
| se | | | | | | d Ø | d ₁ Ø | l ₁ | l | | | | |
| 25 | 35 | 344 R | 6 | 6,3 | 12 | 12 | 6,8 | 20 | 58 | tabulka strana 3.17 - 3.18 | 0,462 | 1,600 | 10 |
| 35 | 50 | 345 R | 7 | 7,5 | 14 | 14 | 8 | 22 | 71 | | 0,695 | 2,500 | 10 |
| 50 | 70 | 346 R | 8 | 9 | 16 | 16 | 10 | 25 | 74 | | 1,037 | 3,300 | 10 |
| 70 | 95 | 347 R | 10 | 10,5 | 18 | 18,5 | 11,5 | 30 | 87 | | 1,958 | 5,400 | 10 |
| 95 | 120 | 348 R | 12 | 12,5 | 22 | 23 | 13,2 | 33 | 91 | | 3,112 | 8,700 | 10 |
| 120 | 150 | 349 R | 12 | 14 | 22 | 23 | 15 | 38 | 97 | | 3,598 | 9,000 | 10 |
| 150 | 185 | 350 R | 12 | 15,8 | 25 | 25,5 | 16,5 | 38 | 108 | | 3,598 | 10,900 | 10 |
| 185 | 240 | 351 R | 14 | 17,5 | 28 | 28,5 | 18,5 | 44 | 116 | | 3,692 | 15,700 | 5 |
| 240 | 300 | 352 R | 16 | 20,3 | 32 | 32,5 | 21,5 | 44 | 128 | | 7,435 | 21,800 | 5 |
| 300 | | 353 R | 18 | 22,5 | 34 | 34,5 | 23,5 | 46 | 131 | | 9,410 | 26,700 | 1 |



AL - CU - LISOVACÍ SPOJKY

pro spojení nenamáhané v tahu
materiál: AL 99,5; E - Cu
povrch: mechanicky leštěno

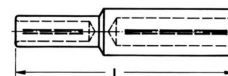

| jmenovitý průřez mm ² ^ | | | obj. číslo | iden. číslo | | rozměr mm | | | nářadí | 100 ks ~ kg | | balení ks | |
|------------------------------------|--------------|--------------|------------|-------------|-----------|------------------|------|-------|-------------------------------------|-------------|-------|-----------|--------|
| Al rm/sm | se | Cu rm/sm | | Al | Cu | vnitřní spojky-Ø | Al | Cu | | l | Cu | | celkem |
| 10 | 16 | 10 | 322 R/10 | 10 | 6 | 5 | 4,5 | 55 | tabulka strana 3.17 - 3.18 | 0,212 | 1,100 | 25 | |
| | 10 | 16 | 322 R/16 | 10 | 8 | 5 | 5,4 | 61 | | 0,714 | 1,550 | | |
| 16 | 25 | 10 | 323 R/10 | 12 | 6 | 6 | 4,5 | 55 | | 0,212 | 1,500 | 25 | |
| | 16 | 25 | 323 R/16 | 12 | 8 | 6 | 5,4 | 61 | | 0,714 | 1,750 | | |
| 25 | 35 | 10 | 324 R/10 | 12 | 6 | 6,8 | 4,5 | 55 | | 0,212 | 1,400 | 25 | |
| | 25 | 35 | 324 R/16 | | 8 | 6,8 | 5,5 | 61 | | 0,714 | 1,650 | | |
| 25 | 35 | 25 | 324 R/25 | 10 | 6,8 | 7 | 61 | 0,892 | | 1,900 | | | |
| 25 | 35 | 35 | 324 R/35 | 12 | 6,8 | 8,2 | 61 | 1,624 | | 2,000 | | | |
| 25 | 35 | 50 | 324 R/50 | 14 | 6,8 | 10 | 72 | 2,362 | | 3,500 | | | |
| 25/4 | 35 re | 16 | 324 R/416 | 8 | 7,6 | 5,5 | 61 | 0,714 | | 1,600 | | | |
| 25/4 | 35 re | 25 | 324 R/425 | 10 | 7,6 | 7 | 61 | 0,892 | | 1,850 | | | |
| 35 | 50 | 16 | 325 R/16 | 14 | 8 | 8 | 5,5 | 71 | | 0,714 | 2,500 | | 25 |
| | 35 | 50 | 325 R/25 | | 10 | 8 | 7 | 71 | | 0,892 | 2,650 | | |
| | 35 | 50 | 325 R/35 | | 12 | 8 | 8,2 | 71 | | 1,519 | 3,300 | | |
| | 35 | 50 | 325 R/50 | | 14 | 8 | 10 | 77 | | 2,362 | 3,530 | | |
| | 35/6 | 50 re | 16 | | 325 R/616 | 8 | 9 | 5,5 | | 71 | 0,714 | 2,450 | |
| | 35/6 | 50 re | 25 | | 325 R/625 | 10 | 9 | 7 | | 71 | 0,892 | 2,600 | |
| | 35/6 | 50 re | 35 | | 325 R/635 | 12 | 9 | 8,2 | | 71 | 1,624 | 3,250 | |
| 50 | 70 | 16 | 326 R/16 | 16 | 8 | 9,8 | 5,5 | 71,5 | 0,714 | 2,850 | 25 | | |
| | | 25 | 326 R/25 | | 10 | 7 | 71,5 | 0,892 | 3,200 | | | | |
| | | 35 | 326 R/35 | | 12 | 8,2 | 71,5 | 1,624 | 3,800 | | | | |
| | | 50 | 326 R/50 | | 14 | 10 | 77,5 | 2,362 | 4,550 | | | | |
| 70 | 95 | 16 | 327 R/16 | 18 | 8 | 11,2 | 5,5 | 79 | 0,714 | 4,100 | 10 | | |
| | | 25 | 327 R/25 | | 10 | 7 | 79 | 0,892 | 3,950 | | | | |
| | | 35 | 327 R/35 | | 12 | 8,2 | 79 | 1,624 | 4,900 | | | | |
| | | 50 | 327 R/50 | | 14 | 10 | 85 | 2,362 | 5,700 | | | | |
| | | 70 | 327 R/70 | | 16 | 11,5 | 86 | 2,921 | 7,250 | | | | |
| | | 95 | 327 R/95 | | 18 | 13,5 | 95 | 4,957 | 9,360 | | | | |
| | | 120 | 327 R/120 | | 20 | 15,5 | 99 | 5,640 | 10,540 | | | | |
| 95 | 120 | 16 | 328 R/16 | 22 | 8 | 13,2 | 5,5 | 79 | 0,714 | 6,150 | 10 | | |
| | | 25 | 328 R/25 | | 10 | 7 | 79 | 0,892 | 6,300 | | | | |
| | | 35 | 328 R/35 | | 12 | 8,2 | 79 | 1,519 | 6,800 | | | | |
| | | 50 | 328 R/50 | | 14 | 10 | 85 | 2,362 | 8,050 | | | | |
| | | 70 | 328 R/70 | | 16 | 11,5 | 87 | 3,105 | 8,200 | | | | |
| | | 95 | 328 R/95 | | 18 | 13,5 | 95 | 4,957 | 10,350 | | | | |
| | | 120 | 328 R/120 | | 20 | 15,5 | 95 | 5,640 | 11,550 | | | | |

AL - CU - LISOVACÍ SPOJKY

pro spojení nenamáhané v tahu
 materiál: AL 99,5; E - Cu
 povrch: mechanicky leštěno

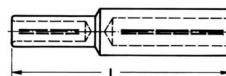

| jmenovitý průřez mm ² | | | obj. číslo | iden. číslo | | rozměr mm | | | nářadí | 100 ks ~ kg | | balení ks |
|----------------------------------|------------|------------|------------|-------------|----|-----------|------|-------|-------------------------------------|-------------|--------|-----------|
| Al rm/sm | Cu se | rm/sm | | Al | Cu | Al | Cu | l | | Cu | celkem | |
| 120 | 150 | 35 | 329 R/35 | 22 | 12 | 14,7 | 8,2 | 81 | tabulka strana 3.17 - 3.18 | 1,519 | 7,600 | 10 |
| | | 50 | 329 R/50 | | 14 | | 10 | 87 | | 4,362 | 7,900 | |
| | | 70 | 329 R/70 | | 16 | | 11,5 | 89 | | 3,105 | 8,500 | |
| | | 95 | 329 R/95 | | 18 | | 13,5 | 97 | | 4,957 | 11,000 | |
| | | 120 | 329 R/120 | | 20 | | 15,5 | 97 | | 5,640 | 10,280 | |
| 150 | 185 | 16 | 330 R/16 | 25 | 8 | 16,3 | 5,4 | 91,5 | | 0,714 | 7,800 | 10 |
| | | 25 | 330 R/25 | | 10 | | 6,8 | 91,5 | | 0,892 | 8,000 | |
| | | 35 | 330 R/35 | | 12 | | 8,2 | 91,5 | | 1,624 | 8,400 | |
| | | 50 | 330 R/50 | | 14 | | 10 | 98,5 | | 2,362 | 10,200 | |
| | | 70 | 330 R/70 | | 16 | | 11,5 | 99,5 | | 3,105 | 10,350 | |
| | | 95 | 330 R/95 | | 18 | | 13,5 | 107,5 | | 4,957 | 12,650 | |
| | | 120 | 330 R/120 | | 20 | | 15,5 | 107,5 | | 5,640 | 13,900 | |
| | | 150 | 330 R/150 | | 22 | | 17 | 124 | | 8,231 | 16,700 | |
| 185 | 240 | 50 | 331 R/50 | 28 | 14 | 18,3 | 10 | 99 | | 2,362 | 12,100 | 5 |
| | | 70 | 331 R/70 | | 16 | | 11,2 | 100 | | 3,105 | 13,000 | |
| | | 95 | 331 R/95 | | 18 | | 13,5 | 108 | | 4,957 | 14,450 | |
| | | 120 | 331 R/120 | | 20 | | 15,5 | 108 | | 5,640 | 13,720 | |
| | | 150 | 331 R/150 | | 22 | | 17 | 113 | | 8,231 | 19,550 | |
| | | 185 | 331 R/185 | | 25 | | 19 | 116 | | 9,621 | 21,000 | |
| | | | | | | | | | | | | |
| 240 | 300 | 50 | 332 R/50 | 32 | 14 | 21 | 10 | 110 | | 2,362 | 16,500 | 5 |
| | | 70 | 332 R/70 | | 16 | | 11,2 | 111 | | 3,105 | 18,000 | |
| | | 95 | 332 R/95 | | 18 | | 13,5 | 119 | | 4,957 | 19,000 | |
| | | 120 | 332 R/120 | | 20 | | 15,5 | 119 | | 5,640 | 20,500 | |
| | | 150 | 332 R/150 | | 22 | | 17 | 124 | | 8,231 | 23,300 | |
| | | 185 | 332 R/185 | | 25 | | 19 | 127 | | 9,621 | 25,500 | |
| | | 240 | 332 R/240 | | 28 | | 21,5 | 128 | | 12,705 | 30,100 | |
| 300 | | 120 | 333 R/120 | 34 | 20 | 23,5 | 15,5 | 119 | | 5,640 | 27,800 | 1 |
| | | 150 | 333 R/150 | | 22 | | 17 | 124 | | 8,234 | 31,100 | |
| | | 185 | 333 R/185 | | 25 | | 19 | 127 | | 9,621 | 32,700 | |
| | | 240 | 333 R/240 | | 28 | | 21,5 | 128 | | 12,705 | 37,500 | |
| | | 300 | 333 R/300 | | 32 | | 24,5 | 134 | | 16,099 | 41,700 | |





PŘÍRAZENÍ PRŮŘEZŮ A PRODUKTŮ K DOPORUČENÉMU NÁŘADÍ

Lisovací kabelová oka a

spojky z E-Al/Al-Cu, katalogové strany 3.03-3.11, 3.14-3.16
lisovací spojky pro spojení namáhané v tahu Al vodičů DIN 48201
list 5,16-95 mm², katalog strana 3.12

| lisovací rozsah mm ² | nářadí | | lisovací tvar | katalog strana |
|---------------------------------|-------------------|---|---------------|----------------|
| | | | | |
| 10 – 70 | EK 35/4 | ● | ○ | 10.15 |
| 10 – 185 | K 18 | ● | ○ | 9.20 |
| | HK 60/18 | ● | ○ | 10.03 |
| | EK 18-plus | ● | ○ | 10.16 |
| | PK 18 | ● | ○ | 10.29 |
| | THK 18 | ● | ○ | 10.41 |
| | HK 60 UNV + UA 18 | ● | ○ | 10.12 |
| | EK 60 UNV + UA 18 | ● | ○ | 10.27 |
| | PK 60 UNV + UA 18 | ● | ○ | 10.40 |
| 10 – 240 | K 22 | ● | ○ | 9.21 |
| | HK 60/22 | ● | ○ | 10.04 |
| | EK 22-plus | ● | ○ | 10.17 |
| | PK 22 | ● | ○ | 10.30 |
| | THK 22 | ● | ○ | 10.42 |
| | HK 60 UNV + UA 22 | ● | ○ | 10.12 |
| | EK 60 UNV + UA 22 | ● | ○ | 10.27 |
| | PK 60 UNV + UA 22 | ● | ○ | 10.40 |
| | HK 120/25 | ● | ○ | 10.07 |
| | HK 120/42 | ● | ○ | 10.08 |
| | HK 120 U | ● | ○ | 10.09 |
| | EK 120/25 | ● | ○ | 10.20 |
| | EK 120/42 | ● | ○ | 10.21 |
| | EK 120 U-plus | ● | ○ | 10.22 |
| | HK 12/2 | ● | ○ | 10.43 |
| | HK 12/2 EL | ● | ○ | 10.48 |
| PK 120/38 | ● | ○ | 10.33 | |
| PK 120 U | ● | ○ | 10.34 | |
| 10 – 500 | HK 25/2 | ● | ○ | 10.44 |
| | HK 25/2 EL | ● | ○ | 10.48 |
| | PK 25/2 | ● | ○ | 10.35 |
| 150 – 500 | HK 45 | ● | ○ | 10.45 |
| | PK 45 | ● | ○ | 10.36 |

Lisovací spojení pro

spojení namáhané v tahu Aldrey lan podle DIN 48201, část 6 a Al vodičů
DIN 48201 část 5, 120-300 mm²,
katalog strana 3.12

| lisovací rozsah mm ² | nářadí | | lisovací tvar | katalog strana |
|---------------------------------|-------------------|---|---------------|----------------|
| | | | | |
| 25 – 50 | EK 35/4 | ● | ○ | 10.15 |
| 25 – 95 | K 18 | ● | ○ | 9.20 |
| | HK 60/18 | ● | ○ | 10.03 |
| | EK 18-plus | ● | ○ | 10.16 |
| | PK 18 | ● | ○ | 10.29 |
| | THK 18 | ● | ○ | 10.41 |
| | HK 60 UNV + UA 18 | ● | ○ | 10.12 |
| | EK 60 UNV + UA 18 | ● | ○ | 10.27 |
| | PK 60 UNV + UA 18 | ● | ○ | 10.40 |
| 25– 185 | K 22 | ● | ○ | 9.21 |
| | HK 60/22 | ● | ○ | 10.04 |
| | EK 22-plus | ● | ○ | 10.17 |
| | PK 22 | ● | ○ | 10.30 |
| | THK 22 | ● | ○ | 10.42 |
| | HK 60 UNV + UA 22 | ● | ○ | 10.12 |
| | EK 60 UNV + UA 22 | ● | ○ | 10.27 |
| | PK 60 UNV + UA 22 | ● | ○ | 10.40 |
| | HK 120/25 | ● | ○ | 10.07 |
| | HK 120/42 | ● | ○ | 10.08 |
| | HK 120 U | ● | ○ | 10.09 |
| | EK 120/25 | ● | ○ | 10.20 |
| | EK 120/42 | ● | ○ | 10.21 |
| | EK 120 U-plus | ● | ○ | 10.22 |
| | HK 12/2 | ● | ○ | 10.43 |
| | HK 12/2 EL | ● | ○ | 10.48 |
| PK 120/38 | ● | ○ | 10.33 | |
| PK 120 U | ● | ○ | 10.34 | |
| 25– 300 | HK 25/2 | ● | ○ | 10.44 |
| | HK 25/2 EL | ● | ○ | 10.48 |
| | PK 25/2 | ● | ○ | 10.35 |
| 150 – 300 | HK 45 | ● | ○ | 10.45 |
| | PK 45 | ● | ○ | 10.36 |

PŘÍRAZENÍ PRŮŘEZŮ A PRODUKTŮ K DOPORUČENÉMU NÁŘADÍ

Lisovací spojky pro spojení

nenamáhané v tahu Al/Fe lan dle DIN 48204, lisovací spojky pro spojení namáhaná v tahu podle DIN 48085, část 3 pro Al/Fe lana podle DIN 48204, katalog strana 3.13

| lisovací rozsah mm ² | nářadí | | lisovací tvar | katalog strana | |
|---------------------------------|--------------------------------------|-------------------------------------|---------------|----------------|-------|
| | mechanické bez vyměnitelných čelistí | mechanické s vyměnitelnými čelistmi | | | |
| 25/4 – 120/20 | | | ● | ○ | 9.21 |
| | K 22 | | ● | ○ | 10.04 |
| | HK 60/22 | | ● | ○ | 10.17 |
| | EK 22-plus | | ● | ○ | 10.30 |
| | PK 22 | | ● | ○ | 10.42 |
| | THK 22 | | ● | ○ | 10.12 |
| | HK 60 UNV + UA 22 | | ● | ○ | 10.27 |
| | EK 60 UNV + UA 22 | | ● | ○ | 10.40 |
| | PK 60 UNV + UA 22 | | ● | ○ | 10.07 |
| | HK 120/25 | | ● | ○ | 10.08 |
| | HK 120/42 | | ● | ○ | 10.09 |
| | HK 120 U | | ● | ○ | 10.20 |
| | EK 120/25 | | ● | ○ | 10.21 |
| | EK 120/42 | | ● | ○ | 10.22 |
| | EK 120 U-plus | | ● | ○ | 10.43 |
| | HK 12/2 | | ● | ○ | 10.48 |
| | HK 12/2 EL | | ● | ○ | 10.33 |
| | PK 120/38 | | ● | ○ | 10.34 |
| | PK 120 U | | ● | ○ | 10.44 |
| | HK 25/2 | | ● | ○ | 10.48 |
| HK 25/2 EL | | ● | ○ | 10.35 | |
| PK 25/2 | | ● | ○ | | |